



NA - 2020

Little Darling - Play with Me

PRODUCT NAME	Baby Kisses
ITEM #	3310
LANGUAGE	2L - English and Spanish
SIZE	8.5"(W) x 11"(H)
TYPE	Platform box
COLOR	K
DATE	24 July 2020
DESIGNER / ARTIST	Cow
FILE NAME	2020_Little Darlings_3310_Baby Kisses_Platform box_PACKAGING_R1.ai

English

Color: Black

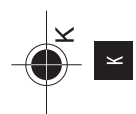

Baby Kisses™

HOW TO PLAY:

- 1) Turn the ON/OFF switch on the battery case to the "ON" position.
- 2) Wave hand in front of doll to activate.
- 3) The doll makes sounds and blows kisses to you.
- 4) Wave hand in front of doll again to re-activate after she stops.
- 5) Please switch back to "OFF" position if you do not want to continue playing. This will save battery life.

BATTERY INSTALLATION :

1. Locate the battery compartment on back of the doll.
2. Have an adult use a small Phillips® screwdriver to remove the battery compartment top.
3. Insert 3 AAA size batteries following polarity markings. We recommend using alkaline batteries.

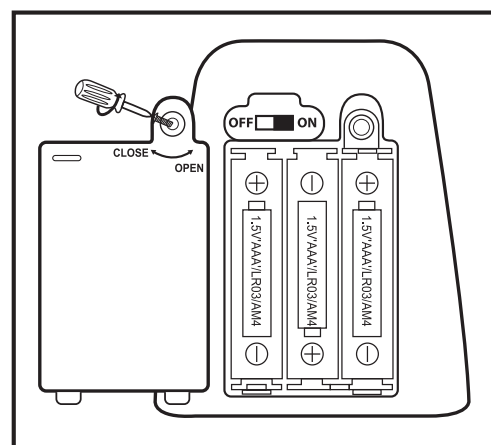

IMPORTANT: ONLY PARENTS / ADULTS SHOULD REPLACE BATTERIES.

- 1) Do not recharge non-rechargeable batteries.
- 2) Do not dispose of batteries in fire; they may leak or explode.
- 3) Do not mix alkaline, standard (carbon-zinc) or rechargeable (nickel-cadmium) batteries.
- 4) Do not mix old and new batteries.
- 5) Use only batteries of the same or equivalent type as recommended by the manufacturer.
- 6) Be sure to insert batteries with correct polarities and always follow package and battery manufacturer's instructions.
- 7) Remove exhausted batteries from product.
- 8) Do not short-circuit supply terminals.
- 9) Keep these instructions for the future because they contain important information.
- 10) Rechargeable batteries are to be removed from the toy before being charged. (If removable).
- 11) Rechargeable batteries are only to be charged under adult supervision. (If removable).

CLEANING THE DOLL:

1. Use a damp cloth to wipe off the doll.
2. Do not put the doll in a washing machine.

For Product Questions:

Call Customer Service 1-866-559-8697 Monday-Friday 9am-6pm (Number is only available in the U.S. and Canada. Eastern Standard Time) or e-mail us : customerservice@newadventuresllc.com

Please keep these instructions for future reference as they contain important information.

CAUTION: All ties or fasteners are not part of this toy and should be removed before giving it to your child. Color and product may vary from photo. Conforms to the safety requirements of ASTM-F963.

FCC statement:

This device complies with part 15 of the FCC Rules. Operation is subject to the following two conditions: (1) This device may not cause harmful interference, and (2) this device must accept any interference received, including interference that may cause undesired operation.

Caution: changes or modifications not expressly approved by the party responsible for compliance could void the user's authority to operate the equipment.

NOTE: This equipment has been tested and found to comply with the limits for a Class B digital device, pursuant to Part 15 of the FCC Rules. These limits are designed to provide reasonable protection against harmful interference in a residential installation. This equipment generates, uses and can radiate radio frequency energy and, if not installed and used in accordance with the instructions, may cause harmful interference to radio communications. However, there is no guarantee that interference will not occur in a particular installation. If this equipment does cause harmful interference to radio or television reception, which can be determined by turning the equipment off and on, the user is encouraged to try to correct the interference by one or more of the following measures: Reorient or relocate the receiving antenna. Increase the separation between the equipment and receiver. Connect the equipment into an outlet on a circuit different from that to which the receiver is connected. Consult the dealer or experienced radio/TV technician for help.

2+



©2020 New Adventures LLC LTD.,
Energy Plaza, TST, KLN, HONG KONG
www.newadventuresllc.com
MADE IN CHINA (DONGGUAN)

P1



Size: 8.5" x 11"

Spanish

Color: Black



Baby Kisses™

CÓMO JUGAR:

- 1) Coloque el interruptor ON/OFF del compartimento de las pilas en la posición "ON".
- 2) Pase la mano por la cara de la muñeca para activarlo.
- 3) La muñeca hace sonidos y te sopla besitos.
- 4) Pase de nuevo la mano por la cara de la muñeca para volver a activarlo cuando se pare.
- 5) Coloque el interruptor en la posición "OFF" si no quiere seguir jugando. Así las pilas durarán más tiempo.

INSTALACIÓN DE LAS BATERÍAS:

1. Ubique el compartimento de las batería al espalda de la muñeca.
2. Un adulto debe abrir la tapa del compartimento de las pilas con un destornillador Phillips® pequeño.
3. Coloque 3 pilas de tamaño AAA según la polaridad indicada. Se recomienda utilizar pilas alcalinas.

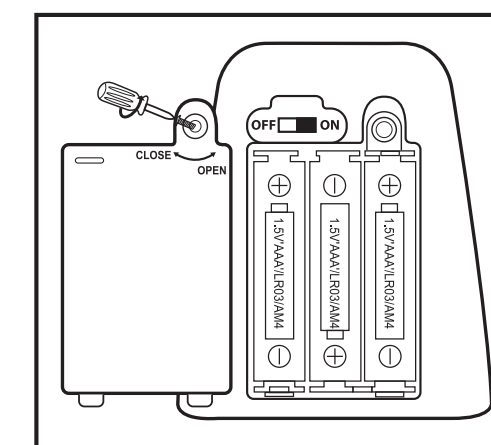

IMPORTANTE: SOLAMENTE LOS PADRES / ADULTOS DEBEN REEMPLAZAR LAS BATERÍAS.

- 1) No recargue baterías no recargables.
- 2) No tire las baterías al fuego, ellas pueden chorrear o explotar.
- 3) No mezcle baterías alcalinas, standard (carbón - zinc) o recargables (níquel - cadmium).
- 4) No mezcle baterías nuevas con viejas.
- 5) Use solamente baterías del mismo tipo o de tipo equivalente como lo recomienda el fabricante.
- 6) Asegúrese de colocar las baterías en la polaridad correcta y siempre siga las instrucciones del paquete y del fabricante de las baterías.
- 7) Quite las baterías que estén agotadas.
- 8) No haga corto circuito con los terminales.
- 9) Guarde estas instrucciones porque contienen información importante que puede necesitar en el futuro.
- 10) Las baterías recargables deben ser quitadas del juguete antes de recargarlas.
- 11) Las baterías deben ser recargadas sólo bajo la supervisión de un adulto.

2+



©2020 New Adventures LLC LTD.,
Energy Plaza, TST, KLN, HONG KONG
www.newadventuresllc.com
MADE IN CHINA (DONGGUAN)

P2



Size: 8.5" x 11"